

June 11, 2021

Mr. Lance McIntyre  
Clark College  
1933 Ft. Vancouver Way  
Vancouver, WA 98686

Subject: Notification of Boiler Installation at Clark College - Main Campus  
(SUN – 264)

Dear Mr. McIntyre:

The Southwest Clean Air Agency (SWCAA) received your Small Unit Notification (SUN) on June 2, 2021 for installation and operation of a new boiler at Clark College's T Building on the Main campus. For administrative and tracking purposes SWCAA has assigned tracking number SUN-264 to this notification. This notification was filed in accordance with SWCAA 400-072 and applies to the installation of one boiler. The new boiler was identified as:

Lochinvar model KBX1000N, natural gas fired condensing boiler with a rated heat input capacity of 0.999 MMBtu/hr. The boiler will be identified as the "T Building Boiler."

SWCAA has completed a review of your notification and the associated support information and has determined that the notification meets the requirements of SWCAA 400-072(2). Once installed, affected equipment must maintain compliance with the requirements of SWCAA 400-072(5)(b) "**Small gas fired boilers/heaters**". A copy of the relevant SWCAA 400-072 section is attached for your information. SWCAA 400-072(5)(b)(v) requires that emissions from the unit be tested within 60 days of initial operation and annually thereafter. Because you have another boiler that requires testing, SWCAA hereby approves the utilization of the currently approved testing schedule for the other boiler at the Main campus for all subsequent testing of the new boiler. The currently approved testing schedule for the other boiler at the Main campus requires that boiler testing be conducted by the end of November each year.

Be advised that emission units installed pursuant to SWCAA 400-072 are subject to source registration and periodic inspection. Registration fees for this equipment will be invoiced consistent with SWCAA 400-100.

If you need further assistance or have any questions regarding these matters, please contact me at (360) 574-3058 extension 130.

Sincerely,



Paul T. Mairose  
Chief Engineer



## SWCAA 400-072 Emission Standards for Selected Small Source Categories

[Statutory Authority: Chapter 70.94.141 RCW. Original adoption 09-21-056 filed 10/15/09, effective 11/15/09, 16-19-009 filed 9/8/16, effective 10/9/16; 17-11-078 filed 5/18/17, effective 6/18/17; 20-06-003 filed 2/19/20, effective 3/21/20]

### (5) Source categories.

#### (b) Small gas fired boilers/heaters.

- (i) **Applicability.** The provisions of this section apply to gas fired (natural gas/propane/LPG) boilers and heaters with individual rated heat inputs equal to or greater than 0.4 MMBtu/hr and equal to or less than 2.0 MMBtu/hr. For the purposes of this subsection, the term "boiler" means any combustion equipment designed to produce steam or to heat water that is not used exclusively to produce electricity for sale.
- (ii) **Emission limits and standards.**
  - (A) Visible emissions from the boiler exhaust stack shall not exceed zero percent opacity for more than 3 minutes in any one hour period as determined in accordance with SWCAA Method 9. (SWCAA 400, Appendix A).
  - (B) Each boiler/heater shall be equipped with combustion technology capable of maintaining NO<sub>x</sub> and CO emissions at, or below, 30 ppmv and 50 ppmv, respectively (corrected to 3% O<sub>2</sub>, dry, 1-hr avg). EPA test methods from 40 CFR 60 (as in effect on the date cited in SWCAA 400-025) shall be used to determine compliance.
- (iii) **General requirements.**
  - (A) Each boiler/heater shall only be fired on natural gas, propane, or LPG.
- (iv) **Monitoring and recordkeeping requirements.** The information listed below shall be recorded at the specified intervals and maintained in a readily accessible form for a minimum of 3 years. With the exception of data logged by a computerized data acquisition system, each required record shall include the date and the name of the person making the record entry.
  - (A) Quantity of fuel consumed by the boiler/heater shall be recorded for each calendar month;
  - (B) Maintenance activities for the boiler/heater shall be logged for each occurrence;
  - (C) Upset conditions that cause excess emissions shall be recorded for each occurrence; and
  - (D) All air quality related complaints received by the permittee and the results of any subsequent investigation or corrective action shall be recorded promptly after each occurrence.
- (v) **Testing requirements.**
  - (A) Each boiler/heater shall undergo emission monitoring no later than 60 calendar days after commencing initial operation. Subsequent monitoring shall be conducted annually thereafter no later than the end of the month in which the original monitoring was conducted. All emission monitoring shall be conducted in accordance with the requirements of SWCAA 400-106(2).
  - (B) If emission monitoring results for a boiler/heater indicate that emission concentrations may exceed 30 ppmvd NO<sub>x</sub> or 50 ppmvd CO, corrected to 3% O<sub>2</sub>, the owner or operator shall either perform 60 minutes of additional monitoring to more accurately quantify CO and NO<sub>x</sub>

emissions, or initiate corrective action. Corrective action shall be initiated as soon as practical but no later than 3 business days after the potential exceedance is identified. Corrective action includes burner tuning, maintenance by service personnel, limitation of unit load, or other action taken to lower emission concentrations. Corrective action shall be pursued until observed emission concentrations no longer exceed 30 ppmvd NO<sub>x</sub> or 50 ppmvd CO, corrected to 3% O<sub>2</sub>.

(vi) **Reporting requirements.**

- (A) The owner or operator of an affected emission unit shall provide written notification of initial operation to SWCAA within 10 days of occurrence.
- (B) All air quality related complaints received by the owner or operator shall be reported to the Agency within 3 business days of receipt.
- (C) Emission monitoring results for each boiler/heater shall be reported to the Agency within 15 calendar days of completion on forms provided by the Agency.
- (D) The owner or operator of an affected boiler/heater shall report the following information to the Agency no later than March 15<sup>th</sup> for the preceding calendar year:
  - (I) Quantity of fuel consumed; and
  - (II) Air emissions of criteria air pollutants, VOCs, and toxic air pollutants (TAPs).

**Summary Information (by SWCAA) for SUN-264  
Clark College – Main Campus  
June 11, 2021**

One Lochinvar Knight series condensing boiler, model KBX1000N, was installed to replace one AERCO MLX-909 boiler (previously referred to as the T Building Boiler).

**New Boiler Information**

Boiler Identification: T Building Boiler  
Replaces: AERCO MLX-909, 0.909 MMBtu/hr boiler, S/N 909-06-0029  
Boiler Make/Model: Lochinvar / KBX1000N  
Boiler Description: Forced draft, condensing boiler with pre-mix surface combustion burner. This boiler meets SCAQMD Rule 1146.2 standards  
Turndown Ratio: 10:1  
Serial Number: 2109 123351108  
Installed: Installation completed May 14, 2021  
Built: February or March 2021 (serial number indicates built "9<sup>th</sup> week" of 2021)  
Heat Input Rating: 0.999 MMBtu/hr  
Fuel: Natural gas  
Stack Description: Discharging vertically through the roof with ~6" diameter stack, approximately 10' above the roof, and approximately 20' above ground level. The stack does not utilize a rain cap. ~ 45°38'14.90"N, 122°39'6.67"W  
Applicable Federal Regulations: None

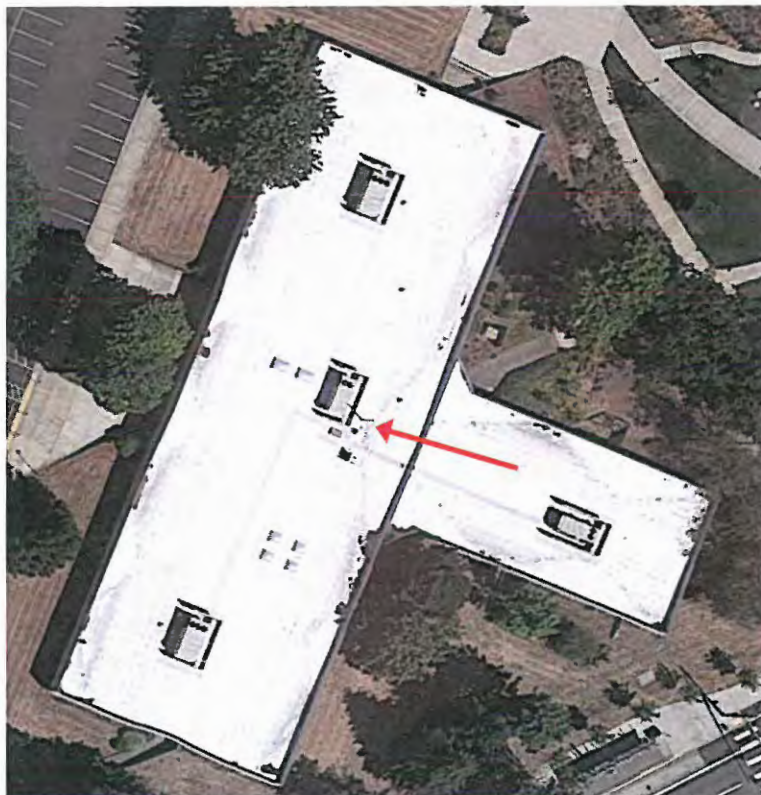

**Google Earth Image – August 13, 2020**

## Potential Emissions

### Clark College - Main Campus - T Building Boiler - Lochinvar

Heat Rate = 0.999 MMBtu/hr  
 Natural Gas Heat Value = 1,020 Btu/scf for AP-42 emission factors  
 Natural Gas Heat Value = 1,026 Btu/scf for 40 CFR 98 GHG emission factors  
 Fuel Consumption = 8.580 MMscf/yr

Pollutant	ppmvd @ 3% O <sub>2</sub>	Emission Factor		lb/hr	tpy	Emission Factor Source
		lb/MMBtu	lb/MMscf			
NO <sub>x</sub>	30	0.0364	37.1	0.036	0.16	SWCAA 400-072
CO	50	0.0370	37.7	0.037	0.16	SWCAA 400-072
VOC		0.0054	5.5	0.0054	0.024	AP-42 Sec. 1.4 (7/98)
SO <sub>x</sub> as SO <sub>2</sub>		0.00059	0.6	0.00059	0.0026	AP-42 Sec. 1.4 (7/98)
PM		0.0075	7.6	0.0074	0.033	AP-42 Sec. 1.4 (7/98)
PM <sub>10</sub>		0.0075	7.6	0.0074	0.033	AP-42 Sec. 1.4 (7/98)
PM <sub>2.5</sub>		0.0075	7.6	0.0074	0.033	AP-42 Sec. 1.4 (7/98)
Benzene		2.06E-06	0.0021	2.1E-06	9.0E-06	AP-42 Sec. 1.4 (7/98)
Formaldehyde		7.35E-05	0.075	7.3E-05	3.2E-04	AP-42 Sec. 1.4 (7/98)
Greenhouse			CO <sub>2</sub> e	CO <sub>2</sub> e		
Gases	kg/MMBtu	GWP	lb/MMBtu	lb/MMscf	tpy, CO <sub>2</sub> e	Emission Factor Source
CO <sub>2</sub>	53.06	1	116.977	120,018.685	511.848	40 CFR 98
CH <sub>4</sub>	0.001	25	0.055	56.549	0.241	40 CFR 98
N <sub>2</sub> O	0.0001	298	0.066	67.406	0.287	40 CFR 98
Total GHG - CO <sub>2</sub> e			117.098	120,142.640	512.377	