



11815 NE 99th Street, Suite 1294  
Vancouver, WA 98662  
Voice: 360-574-3058  
Fax: 360-576-0925  
Web: <https://www.swcleanair.gov>  
Email: [Tina@swcleanair.gov](mailto:Tina@swcleanair.gov)

## Notice of Intent to Remove Asbestos

Case #: 24-662

Amendment: 0

Date Received: 9/25/2024

Date Paid: 9/24/2024

SWCAA Fee: \$738.00

Receipt #: 163167472

**This notification MUST be present at all times at the asbestos project sit**

### \*\*\* EMERGENCY NOTICE \*\*\*

Quantity to be removed: 180 Square Feet

Linear Feet

Workshift days: W

Project starting date: 9/25/2024

Project Completion date: 9/25/2024

Workshift hours: 10-3

Site Name: Resident

Site address: 20813 NE 72nd Ave

Location of Asbestos: Kitchen

City/State/Zip: Battle Ground

WA

98604

☐ Demolition of Structure (Notification of Demolition required)

County: CLARK COUNTY

☒ Asbestos survey conducted?

No survey reason:

AHERA Inspector: Alex Abrahamson

Certification #: 192231

#### Material to be Removed:

☐ Fireproofing

☐ Popcorn Ceiling

☐ CAB

☐ Sheet Vinyl

☐ Boiler Insulation

☐ Duct Tape

☐ Duct Paper

☐ Mag Pipe Insulation

☐ Air Cell

☐ CA Pipe

☐ VAT

☒ Other Drywall

#### Control Methods:

☒ N.P Enclosure

☐ Glove Bag

☐ Mini Enclosure

☐ Wrap and Cut

☒ Water

☒ HEPA Vac

☐ Other

Asbestos Contractor: Abatement Services of Washington

Phone: 503-765-5257

Mailing Address: PO Box 747, Beaver Creek, OR, 97004

Email: [tristan@abateservices.com](mailto:tristan@abateservices.com)

Certification ##: ABCN00001610

Supervisor: Yessica Grgeorio

Phone: 971-287-1419

Property Owner: Mumm, James

Phone: 3606019099

Mailing Address: 20813 NE 72nd Ave, Battle Ground WA 98604

Asbestos Disposal Site: Hillsboro Landfill: 3205 SE Minter Bridge Rd, Hillsboro, OR, 97123-

**I DO HEREBY CERTIFY THAT THE INFORMATION CONTAINED IN THIS NOTIFICATION IS,  
TO THE BEST OF MY KNOWLEDGE, ACCURATE AND COMPLETE.**

Submitter Name: Ashley Morales

Representing: Abatement Services

Submitter Title:

Date Submitted: 9/25/2024

Reviewed by SWCAA: Mihai Voivod

☒ Approved



11815 NE 99th Street, Suite 1294  
Vancouver, WA 98662  
Voice: 360-574-3058  
Fax: 360-576-0925  
Web: <https://www.swcleanair.gov>  
Email: [Tina@swcleanair.gov](mailto:Tina@swcleanair.gov)

## Notice of Intent to Remove Asbestos

Case #: 24-662

Amendment: 0

Date Received: 9/25/2024

Date Paid: 9/24/2024

SWCAA Fee: \$738.00

Receipt #: 163167472

**This notification MUST be present at all times at the asbestos project sit**



TRUST Assignment Number: 7459

Claim Number: 47-72Q7-08R

# Limited Asbestos and Lead Assessment Survey

## Survey Location:

Mumm Property  
20813 NE 72nd Avenue,  
Battle Ground, WA, 98604

## Report Prepared for:

State Farm Insurance  
Attn: Aldous Harris  
P.O. Box 588002,  
North Metro, GA 30029  
[statefarmfireclaims@statefarm.com](mailto:statefarmfireclaims@statefarm.com)

Survey Date: August 28, 2024

Report Date: August 30, 2024



20813 NE 72nd Avenue,  
Battle Ground, WA, 98604

TRUST Assignment Number: 7459

August 30, 2024

Claim Number: 47-72Q7-08R

State Farm Insurance  
Attn: Aldous Harris  
P.O. Box 588002,  
North Metro, GA 30029  
[statefarmfireclaims@statefarm.com](mailto:statefarmfireclaims@statefarm.com)

## Limited Asbestos and Lead Assessment Survey

### Section I: Site Characterization and Background Information

On August 28, 2024, TRUST Environmental Solutions (TRUST Environmental) conducted a Limited Asbestos and Lead Assessment Survey of the Mumm Property located at 20813 NE 72nd Avenue, Battle Ground, WA, 98604. This survey was completed at the request of State Farm Insurance and was completed by Certified Site Surveillance Technician and Lead Sampling Technician, Alex Abrahamson (Cert # 192231) under the direction of Certified Asbestos Consultant and Lead Inspector/Assessor, Victor Ruiz (CAC# 15-5589 and LRC-00011686) who are employees of TRUST Environmental Solutions located at 317 W. Ventura Blvd., #1067, Camarillo, California 93010. Asbestos samples were hand delivered to:

Eurofins Tustin/Irvine (NVLAP; 200757-0) located at 2841 Dow Avenue, Suite 300, Tustin, CA 92780. EMLab Tustin/Irvine can be reached at (866) 465-6653.

Prior to inspection, TRUST Environmental was informed of a water loss, affecting the interior. Visible damage was noted on the Kitchen Ceiling. No obvious structural or fire damages were observed.

### Section II: Results Summary

RESULT: ☒ Asbestos was Detected

☐ Asbestos was Not Detected

☐ Materials are Lead Based

☐ Materials are Lead Containing

☒ Materials are Lead Safe

Asbestos **was detected** within the Kitchen White Texture with Paint and White Joint Compound.

All materials sampled for lead were found to be **lead safe**.

A total of 6 asbestos PLM bulk samples were collected. 6 samples were analyzed.

\*TRUST Environmental includes the first three (3) layers of material analyzed. Each additional layer analyzed after three (3) is charged as one (1) additional sample. TRUST Environmental is required to analyze each layer of material until positive material is detected or until all layers are analyzed and no asbestos is detected.

A total of 1 lead paint chip sample was collected and analyzed.

Please see Tables I and II below for a summary of the survey results followed by supplemental information including recommendations and testing methodologies.

**Table I: Summary of Asbestos PLM Sample Results**

Sample ID	Building Material Sampled	Result	Quantity	Friability	Condition	P5 Req
1A	Kitchen- White Texture with Paint	2%CH	600sf*	Friable	D	N
1B	Kitchen- White Texture with Paint	2%CH	600sf*	Friable	D	N
2A	Kitchen-Cream Tape	NAD (h)	600sf*	Friable	D	N
2A	Kitchen- White Joint Compound	2%CH	600sf*	Friable	D	N
2B	Kitchen-Cream Tape	NAD (h)	600sf*	Friable	D	N
2B	Kitchen-White Joint Compound	2%CH	600sf*	Friable	D	N
3A	Kitchen-White Drywall with Brown Paper	NAD	600sf*	Friable	D	N
3B	Kitchen-White Drywall with Brown Paper	NAD	600sf*	Friable	D	N

**Reference Legend:**

NAD – No Asbestos Detected, CH – Chrysotile Asbestos

NAD (h) – No Asbestos Detected but material is still considered asbestos containing due to being part of a homogenous area.

NAD (t) – No Asbestos Detected but material is still considered to have trace level asbestos due to being part of a homogenous area.

sf\* - Estimated Square Feet

G - Good, D - Damaged, SD - Significantly Damaged

SCAQMD – South Coast Air Quality Management District, AVAQMD – Antelope Valley Air Quality Management District, VCAPCD – Ventura County Air Pollution Control District

**Table II: Summary of Lead XRF-gun Sample Results**

Sample ID	Location	Color of Material	Type of Material Sampled	Condition	Result
PB-1	Kitchen	White	Ceiling-Paint	Intact	<40mg/kg

### Section III: Recommendations

#### Asbestos Recommendations:

- ☐ NAD - Asbestos was not detected within the sampled area. No further action is required.
- ☐  $\leq 0.1\%$  CH - This material was further analyzed by point count and the asbestos found was determined to be at trace level. Although the material is below quantifiable limits of asbestos, contracted employees should be instructed on wet methods of removal, HEPA vacuuming, prompt clean up, and the prevention of raising dust while work is performed.
- ☐  $< 1\%$  CH - Asbestos was detected in trace amounts in the sampled area. This material may be further analyzed by 1000-point count at the request of the client to determine the method of removal that must be used. If not further analyzed or determined to be  $> 0.1\%$  and  $< 1\%$  CH by point count, this material must be treated as asbestos containing material. Abatement activities must be performed by asbestos trained personnel using proper PPE and controls. The abatement contractor must comply with all local, state, and federal regulations governing the removal and/or disturbance of Asbestos Containing Materials.
- ☒ Greater than 1% CH - Asbestos was detected in amounts greater than 1% CH in the sampled area. This material must be treated as asbestos containing material. Abatement activities must be performed by asbestos trained personnel using proper PPE and controls. The abatement contractor must comply with all local, state, and federal regulations governing the removal and/or disturbance of Asbestos Containing Materials.

#### Lead Recommendations:

- ☒ The material contains  $< 200$  PPM or  $< 0.1$  mg/cm<sup>2</sup> - Material is considered Lead Safe.
- ☐  $< 5000$  PPM or  $< 1.0$  mg/cm<sup>2</sup> - This material is considered Lead Containing and does NOT require "Lead Abatement".
- ☐  $\geq 5000$  PPM or  $\geq 1.0$  mg/cm<sup>2</sup> - This material is considered Lead Based Paint and requires "Lead Abatement". This

#### Section IV: Purpose and Methodologies

The purpose of this survey assessment was to identify Asbestos Containing Materials (ACM) and Lead Containing Materials that may be impacted by planned repair, remodel, renovation at the survey location. TRUST Environmental first conducted a visual inspection of the survey location to identify and assess the condition of materials to be sampled.

Bulk material samples of suspected asbestos containing material were collected, categorized into homogenous groupings, labeled a unique sample number for each sample, and placed into a sealed container. Asbestos samples were analyzed via Polarized Light Microscopy (PLM) for asbestos content by an accredited laboratory listed below. Principles described in the EPA 600 method were used in the preparation and analysis of the bulk samples. US EPA government regulation requires that a limited number of samples be collected from each identified homogenous area. If one sample in a homogenous area is determined to be asbestos containing, the entire homogenous area must be considered asbestos containing, even if no asbestos was detected in any other samples within the homogenous area.. No destructive sampling was conducted. As such, any inaccessible areas that would require destructive sampling were not inspected or sampled. All areas that renovation or demolition plans will impact must be inspected or sampled. Asbestos bulk samples were delivered to and analyzed via PLM by an accredited laboratory.

The specific number of samples collected was determined by using the methods required by the Federal AHERA regulations (40 CFR, Part 763.86) as noted below:

1) For Surfacing Material:

1,000 ft<sup>2</sup> or less - collect 3 samples

1,001 to 5,000 ft<sup>2</sup> - collect 5 samples

5,001 ft<sup>2</sup> or greater - collect 7 samples

2) For Thermal System Insulation:

"In a randomly distributed manner" - collect 3 samples

6 linear feet of patching or less - collect 1 sample

cementitious pipe fittings - "In a manner sufficient to determine"

3) For all Miscellaneous Material:

Collect samples "In a manner sufficient to determine whether material is ACM (asbestos containing material) or not ACM."

Lead samples were taken via paint chip and analyzed for lead content.

## Section V: Limitations

TRUST Environmental Solutions presents this report and makes the above recommendations based on limitations of the analytical method, along with independent research and industry consensus. TRUST Environmental and representatives of TRUST Environmental are not licensed as Medical Professionals and can make no medical diagnoses. TRUST Environmental was limited to the conditions and observations present only on the day of inspection. Environmental testing is an imperfect science and Asbestos Surveying is limited. In addition, reports may contain inaccuracies. TRUST Environmental may revise the above content of this report at any time when presented with new information. Any reference to quantities within this report are estimates and are not actual. TRUST Environmental was limited to standard practices, the scope of services, parameters of the analytical method used, and conditions present at the time of inspection.

Thank you for choosing TRUST Environmental Solutions. Please contact us at (805) 72-TRUST or TestIt@TRUSTenv.com for any additional testing needs. Please contact the Reports Department at GetResults@TRUSTenv.com for any questions or requested revisions regarding this report and we would be happy to assist you.

Written By:



David Penglase  
Senior Technical Report Writer  
[GetResults@TRUSTenv.com](mailto:GetResults@TRUSTenv.com)  
(805) 72-TRUST  
TRUST Environmental Solutions

Reviewed By:



Victor Ruiz  
Certified Asbestos Consultant (15-5589) and LRC (00011686)  
Victor.Ruiz@TrustEnv.com  
TRUST Environmental Solutions  
317 W. Ventura Blvd., #1067  
Camarillo, California 93010



## Section VI: Appendices

Please see below for any relevant analytical results, site diagrams, and certifications regarding the above project.

# APPENDIX A – ANALYTICAL RESULTS AND CHAIN OF CUSTODY



Report for:

**Lab Results**  
**TRUST Environmental Solutions**  
317 Ventura Blvd.  
#1067  
Camarillo, CA 93010

---

Regarding: Eurofins EPK Built Environment Testing, LLC  
Project: 7459; 20813 NE 72nd Ave, Battle Ground, WA  
EML ID: 3763843

Approved by:



Approved Signatory  
Danny Li

Dates of Analysis:  
Asbestos PLM: 08-29-2024

Service SOPs: Asbestos PLM (EPA 40CFR App E to Sub E of Part 763 & EPA METHOD 600/R-93-116, SOP EM-AS-S-1267)  
NVLAP Lab Code 200757-0

---

All samples were received in acceptable condition unless noted in the Report Comments portion in the body of the report. The results relate only to the samples as received and tested. The results include an inherent uncertainty of measurement associated with estimating percentages by polarized light microscopy. Measurement uncertainty data for sample results with >1% asbestos concentration can be provided when requested.

Eurofins EPK Built Environment Testing, LLC ("the Company"), a member of the Eurofins Built Environment Testing group of companies, shall have no liability to the client or the client's customer with respect to decisions or recommendations made, actions taken or courses of conduct implemented by either the client or the client's customer as a result of or based upon the Test Results. In no event shall the Company be liable to the client with respect to the Test Results except for the Company's own willful misconduct or gross negligence nor shall the Company be liable for incidental or consequential damages or lost profits or revenues to the fullest extent such liability may be disclaimed by law, even if the Company has been advised of the possibility of such damages, lost profits or lost revenues. In no event shall the Company's liability with respect to the Test Results exceed the amount paid to the Company by the client therefor.

Client: TRUST Environmental Solutions

C/O: Lab Results

Re: 7459; 20813 NE 72nd Ave, Battle Ground, WA

Date of Receipt: 08-29-2024

Date of Report: 08-29-2024

## ASBESTOS PLM REPORT

**Total Samples Submitted:** 6

**Total Samples Analyzed:** 6

**Total Samples with Layer Asbestos Content > 1%:** 4

### Location: 1A, Kitchen Ceiling, Textured Paint

Lab ID-Version‡: 18547296-1

Sample Layers	Asbestos Content
White Texture with Paint	2% Chrysotile
<b>Sample Composite Homogeneity:</b>	Poor

### Location: 1B, Kitchen Ceiling, Textured Paint

Lab ID-Version‡: 18547297-1

Sample Layers	Asbestos Content
White Texture with Paint	2% Chrysotile
<b>Sample Composite Homogeneity:</b>	Poor

### Location: 2A, Kitchen Ceiling, Joint Compound

Lab ID-Version‡: 18547298-1

Sample Layers	Asbestos Content
Cream Tape	ND
White Joint Compound	2% Chrysotile
<b>Composite Non-Asbestos Content:</b>	10% Cellulose
<b>Sample Composite Homogeneity:</b>	Poor

The test report shall not be reproduced except in full, without written approval of the laboratory. The report must not be used by the client to claim product certification, approval, or endorsement by NVLAP, NIST, or any agency of the federal government. The Company reserves the right to dispose of all samples after a period of thirty (30) days, according to all state and federal guidelines, unless otherwise specified.

All components not quantified as asbestos content and non-asbestos content are considered to be non-fibrous matrix components. Matrix components may include, but are not limited to, gypsum, paint, silicate minerals, vinyl, binder, calcium carbonate, tar, and foam.

Inhomogeneous samples are separated into homogeneous subsamples and analyzed individually. ND means no fibers were detected. When detected, the minimum detection and reporting limit is less than 1% unless point counting is performed. Floor tile samples may contain large amounts of interference material and it is recommended that the sample be analyzed by gravimetric point count analysis to lower the detection limit and to aid in asbestos identification.

‡ A "Version" indicated by "-x" after the Lab ID# with a value greater than 1 indicates a sample with amended data. The revision number is reflected by the value of "x".

Client: TRUST Environmental Solutions

C/O: Lab Results

Re: 7459; 20813 NE 72nd Ave, Battle Ground, WA

Date of Receipt: 08-29-2024

Date of Report: 08-29-2024

## ASBESTOS PLM REPORT

### Location: 2B, Kitchen Ceiling, Joint Compound

Lab ID-Version‡: 18547299-1

Sample Layers	Asbestos Content
Cream Tape	ND
White Joint Compound	2% Chrysotile
<b>Composite Non-Asbestos Content:</b>	10% Cellulose
<b>Sample Composite Homogeneity:</b>	Poor

### Location: 3A, Kitchen Ceiling, Drywall

Lab ID-Version‡: 18547300-1

Sample Layers	Asbestos Content
White Drywall with Brown Paper	ND
<b>Composite Non-Asbestos Content:</b>	10% Cellulose
<b>Sample Composite Homogeneity:</b>	Poor

### Location: 3B, Kitchen Ceiling, Drywall

Lab ID-Version‡: 18547301-1

Sample Layers	Asbestos Content
White Drywall with Brown Paper	ND
<b>Composite Non-Asbestos Content:</b>	10% Cellulose
<b>Sample Composite Homogeneity:</b>	Poor

The test report shall not be reproduced except in full, without written approval of the laboratory. The report must not be used by the client to claim product certification, approval, or endorsement by NVLAP, NIST, or any agency of the federal government. The Company reserves the right to dispose of all samples after a period of thirty (30) days, according to all state and federal guidelines, unless otherwise specified.

All components not quantified as asbestos content and non-asbestos content are considered to be non-fibrous matrix components. Matrix components may include, but are not limited to, gypsum, paint, silicate minerals, vinyl, binder, calcium carbonate, tar, and foam.

Inhomogeneous samples are separated into homogeneous subsamples and analyzed individually. ND means no fibers were detected. When detected, the minimum detection and reporting limit is less than 1% unless point counting is performed. Floor tile samples may contain large amounts of interference material and it is recommended that the sample be analyzed by gravimetric point count analysis to lower the detection limit and to aid in asbestos identification.

‡ A "Version" indicated by "-x" after the Lab ID# with a value greater than 1 indicates a sample with amended data. The revision number is reflected by the value of "x".



Report for:

**Lab Results**  
**TRUST Environmental Solutions**  
317 Ventura Blvd.  
#1067  
Camarillo, CA 93010

---

Regarding: Eurofins EPK Built Environment Testing, LLC  
Project: 7459; 20813 NE 72nd Ave, Battle Ground, WA  
EML ID: 3763843

Approved by:



Approved Signatory  
Andrew Arestegui

Dates of Analysis:

Lead - Flame AA: 08-29-2024

Service SOPs: Lead - Flame AA (EM-BC-S-8443)  
AIHA LAP, LLC accredited service, Lab ID #178697

---

All samples were received in acceptable condition unless noted in the Report Comments portion in the body of the report. Due to the nature of the analyses performed, field blank correction of results is not applied. The results relate only to the samples as received and tested. Sample size, as it relates to Wipe samples only, is supplied by the client.

Eurofins EPK Built Environment Testing, LLC ("the Company"), a member of the Eurofins Built Environment Testing group of companies, shall have no liability to the client or the client's customer with respect to decisions or recommendations made, actions taken or courses of conduct implemented by either the client or the client's customer as a result of or based upon the Test Results. In no event shall the Company be liable to the client with respect to the Test Results except for the Company's own willful misconduct or gross negligence nor shall the Company be liable for incidental or consequential damages or lost profits or revenues to the fullest extent such liability may be disclaimed by law, even if the Company has been advised of the possibility of such damages, lost profits or lost revenues. In no event shall the Company's liability with respect to the Test Results exceed the amount paid to the Company by the client therefor.

Eurofins EPK Built Environment Testing, LLC's LabServe® reporting system includes automated fail-safes to ensure that all AIHA LAP, LLC quality requirements are met and notifications are added to reports when any quality steps remain pending.

Client: TRUST Environmental Solutions

C/O: Lab Results

Re: 7459; 20813 NE 72nd Ave, Battle Ground, WA

Date of Receipt: 08-29-2024

Date of Report: 08-29-2024

**LEAD: FLAME ATOMIC ABSORPTION SPECTROMETRY**

Location:	PB-1: Kitchen Ceiling, White Paint
Comments (see below)	A
Lab ID-Version‡:	18547302-1
Analysis Date:	08/29/2024
Sample type	Paint Chip sample
Method*	NIOSH 7082 & EPA 7000B modified
† Method Reporting Limit	40 ppm
Sample size	0.2509 grams
§ Total Lead Result	< 40 ppm

**Comments:** A) The relative percent difference of the matrix duplicate pair was above control limits. The laboratory control sample and matrix blank were both within control limits and validated the batch.

Sample results have not been corrected for blank values.

Bulk samples are not covered under the AIHA LAP, LLC service accreditation.

Wipe samples must meet ASTM E1792 criteria. Method Reporting Limits may not be valid for non-ASTM E1792 wipe samples.

\*Sample preparation and analytical methods are based upon NIOSH 7082 and EPA 7000B.

† The Method Reporting Limit is the minimum concentration of Lead that the laboratory can confidently detect in the sample.

§ Total Lead Result has been rounded to two significant figures to reflect analytical precision.

‡ A "Version" indicated by "-x" after the Lab ID# with a value greater than 1 indicates a sample with amended data. The revision number is reflected by the value of "x".



Environmental  
Solutions

Results Begin With TRUST

TRUST Environmental Solutions

317 W Ventura Blvd., #1067, Camarillo, CA 93010

(805) 72-TRUST | www.TRUSTenv.com | TestIt@TRUSTenv.com

# ASBESTOS & LEAD CHAIN OF CUSTODY RECORD

TRUST Assignment #: 7459

TAT Requested: ☒ 3HR ☐ 24HR ☐ Other \_\_\_\_\_

Client Name: Service Master

Analysis Requested: ☒ PLM ☐ TEM (Wipe) ☐ TEM (MV) ☐ PCM

Site Name: Mumm, James

☒ Lead Paint Chip ☐ Other \_\_\_\_\_

Site Address: 20813 NE 72<sup>nd</sup> Ave, Battle Ground, WA

Sample Count (Specify Type) \_\_\_\_\_

Sample ID	Collection Location	Material Type	F	NF	Condition	Total (Vol./Size)	Additional Notes (Color, P5, etc.)
1A, 1B	Kitchen Ceiling	Texture Paint	X		Damage	600SF	
2A, 2B		Joint Compound	X				
3A, 3B		Drywall	X				
PB-1		White Paint					



003763843

Date & Time: 8/28/24 11:45

Company Name: TRUST Environmental Solutions

Sampling Technician (Print): Alex Abrahamson

Sampling Technician (Sign): [Signature]

Date & Time: 8/29/24 15:05

Company Name: Environ Built Environment

Laboratory Recipient (Print): STEVEN CASTILLO

Laboratory Recipient (Sign): Received By [Signature]

Page \_\_\_\_ of \_\_\_\_

## APPENDIX B – SITE DIAGRAM



## SITE DIAGRAM

TRUST Assignment #: 7459

Client Name: Service Master

Assigned Technician: Alex Abrahamson

Site Name: MUMM, James

Testing Type: Asbestos/Lead

Revisit: ☐ Yes ☒ No

Site Address: 20813 NE 72nd Avenue  
Battle Ground, WA, 98604

Survey Type: ☐ Full ☒ Limited ☐ Other

P5: ☐ Yes ☐ No ☐ N/A

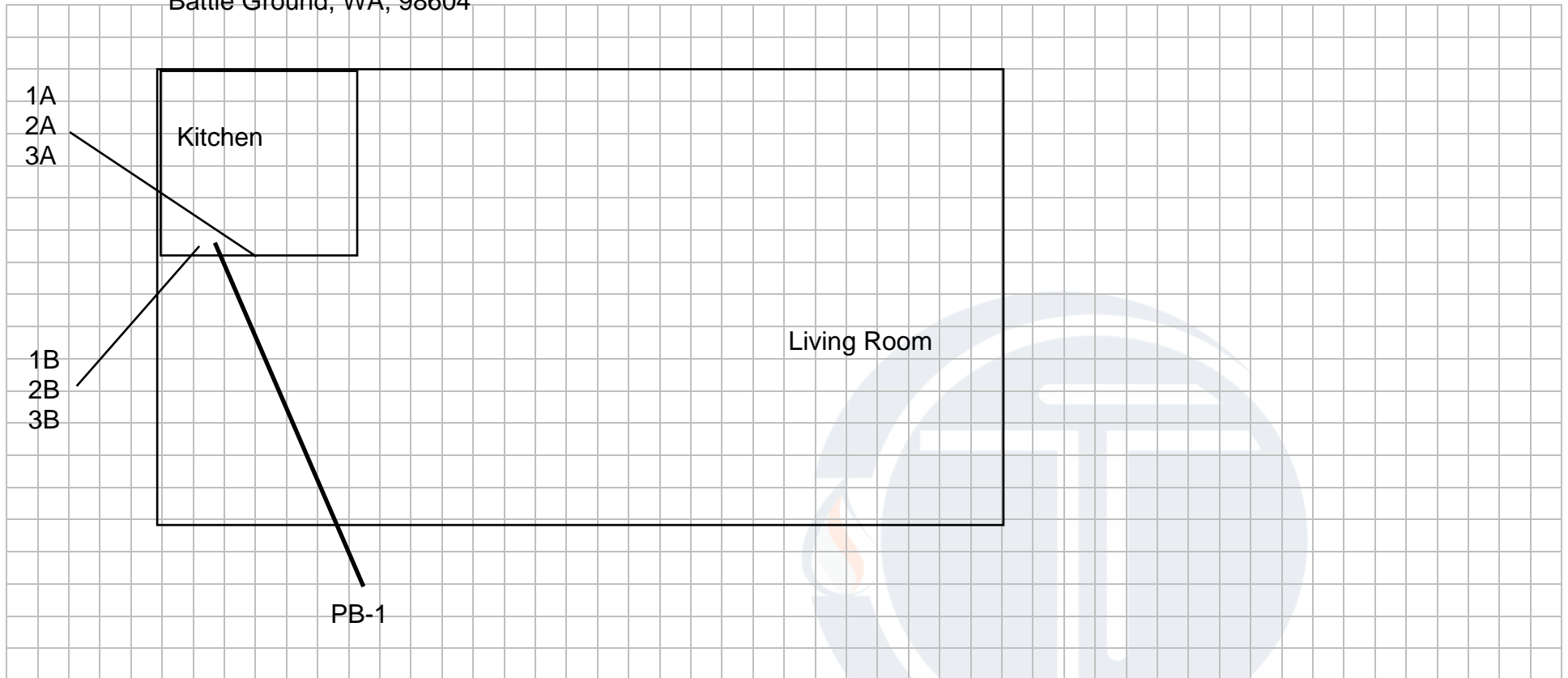

Elevated Moisture: —  
Water Damage: —  
Visible Growth: —

## APPENDIX C – CERTIFICATIONS

# Certificate of Completion

This is to certify that

**Alex J. Abrahamson**

has satisfactorily completed  
4 hours of online refresher training as an  
**AHERA Building Inspector**

to comply with the training requirements of  
**TSCA Title II, 40 CFR 763 (AHERA)**

EPA Provider # 1085

192231  
Certificate Number



Instructor: David Welch

Jan 17, 2024

Expires in 1 year.

Date(s) of Training

Exam Score: N/A  
(if applicable)



- Facilities
- Environmental
- Geotechnical
- Materials



TRUST Assignment Number: 7459

Claim Number: 47-72Q7-08R

# Limited Asbestos and Lead Assessment Survey

## Survey Location:

Mumm Property  
20813 NE 72nd Avenue,  
Battle Ground, WA, 98604

## Report Prepared for:

State Farm Insurance  
Attn: Aldous Harris  
P.O. Box 588002,  
North Metro, GA 30029  
[statefarmfireclaims@statefarm.com](mailto:statefarmfireclaims@statefarm.com)

Survey Date: August 28, 2024

Report Date: August 30, 2024



20813 NE 72nd Avenue,  
Battle Ground, WA, 98604

TRUST Assignment Number: 7459

August 30, 2024

Claim Number: 47-72Q7-08R

State Farm Insurance  
Attn: Aldous Harris  
P.O. Box 588002,  
North Metro, GA 30029  
[statefarmfireclaims@statefarm.com](mailto:statefarmfireclaims@statefarm.com)

## Limited Asbestos and Lead Assessment Survey

### Section I: Site Characterization and Background Information

On August 28, 2024, TRUST Environmental Solutions (TRUST Environmental) conducted a Limited Asbestos and Lead Assessment Survey of the Mumm Property located at 20813 NE 72nd Avenue, Battle Ground, WA, 98604. This survey was completed at the request of State Farm Insurance and was completed by Certified Site Surveillance Technician and Lead Sampling Technician, Alex Abrahamson (Cert # 192231) under the direction of Certified Asbestos Consultant and Lead Inspector/Assessor, Victor Ruiz (CAC# 15-5589 and LRC-00011686) who are employees of TRUST Environmental Solutions located at 317 W. Ventura Blvd., #1067, Camarillo, California 93010. Asbestos samples were hand delivered to:

Eurofins Tustin/Irvine (NVLAP; 200757-0) located at 2841 Dow Avenue, Suite 300, Tustin, CA 92780. EMLab Tustin/Irvine can be reached at (866) 465-6653.

Prior to inspection, TRUST Environmental was informed of a water loss, affecting the interior. Visible damage was noted on the Kitchen Ceiling. No obvious structural or fire damages were observed.

### Section II: Results Summary

RESULT: ☒ Asbestos was Detected

☐ Asbestos was Not Detected

☐ Materials are Lead Based

☐ Materials are Lead Containing

☒ Materials are Lead Safe

Asbestos **was detected** within the Kitchen White Texture with Paint and White Joint Compound.

All materials sampled for lead were found to be **lead safe**.

A total of 6 asbestos PLM bulk samples were collected. 6 samples were analyzed.

\*TRUST Environmental includes the first three (3) layers of material analyzed. Each additional layer analyzed after three (3) is charged as one (1) additional sample. TRUST Environmental is required to analyze each layer of material until positive material is detected or until all layers are analyzed and no asbestos is detected.

A total of 1 lead paint chip sample was collected and analyzed.

Please see Tables I and II below for a summary of the survey results followed by supplemental information including recommendations and testing methodologies.

**Table I: Summary of Asbestos PLM Sample Results**

Sample ID	Building Material Sampled	Result	Quantity	Friability	Condition	P5 Req
1A	Kitchen- White Texture with Paint	2%CH	600sf*	Friable	D	N
1B	Kitchen- White Texture with Paint	2%CH	600sf*	Friable	D	N
2A	Kitchen-Cream Tape	NAD (h)	600sf*	Friable	D	N
2A	Kitchen- White Joint Compound	2%CH	600sf*	Friable	D	N
2B	Kitchen-Cream Tape	NAD (h)	600sf*	Friable	D	N
2B	Kitchen-White Joint Compound	2%CH	600sf*	Friable	D	N
3A	Kitchen-White Drywall with Brown Paper	NAD	600sf*	Friable	D	N
3B	Kitchen-White Drywall with Brown Paper	NAD	600sf*	Friable	D	N

**Reference Legend:**

NAD – No Asbestos Detected, CH – Chrysotile Asbestos

NAD (h) – No Asbestos Detected but material is still considered asbestos containing due to being part of a homogenous area.

NAD (t) – No Asbestos Detected but material is still considered to have trace level asbestos due to being part of a homogenous area.

sf\* - Estimated Square Feet

G - Good, D - Damaged, SD - Significantly Damaged

SCAQMD – South Coast Air Quality Management District, AVAQMD – Antelope Valley Air Quality Management District, VCAPCD – Ventura County Air Pollution Control District

**Table II: Summary of Lead XRF-gun Sample Results**

Sample ID	Location	Color of Material	Type of Material Sampled	Condition	Result
PB-1	Kitchen	White	Ceiling-Paint	Intact	<40mg/kg

### Section III: Recommendations

#### Asbestos Recommendations:

- ☐ NAD - Asbestos was not detected within the sampled area. No further action is required.
- ☐  $\leq 0.1\%$  CH - This material was further analyzed by point count and the asbestos found was determined to be at trace level. Although the material is below quantifiable limits of asbestos, contracted employees should be instructed on wet methods of removal, HEPA vacuuming, prompt clean up, and the prevention of raising dust while work is performed.
- ☐  $< 1\%$  CH - Asbestos was detected in trace amounts in the sampled area. This material may be further analyzed by 1000-point count at the request of the client to determine the method of removal that must be used. If not further analyzed or determined to be  $> 0.1\%$  and  $< 1\%$  CH by point count, this material must be treated as asbestos containing material. Abatement activities must be performed by asbestos trained personnel using proper PPE and controls. The abatement contractor must comply with all local, state, and federal regulations governing the removal and/or disturbance of Asbestos Containing Materials.
- ☒ Greater than 1% CH - Asbestos was detected in amounts greater than 1% CH in the sampled area. This material must be treated as asbestos containing material. Abatement activities must be performed by asbestos trained personnel using proper PPE and controls. The abatement contractor must comply with all local, state, and federal regulations governing the removal and/or disturbance of Asbestos Containing Materials.

#### Lead Recommendations:

- ☒ The material contains  $< 200$  PPM or  $< 0.1$  mg/cm<sup>2</sup> - Material is considered Lead Safe.
- ☐  $< 5000$  PPM or  $< 1.0$  mg/cm<sup>2</sup> - This material is considered Lead Containing and does NOT require "Lead Abatement".
- ☐  $\geq 5000$  PPM or  $\geq 1.0$  mg/cm<sup>2</sup> - This material is considered Lead Based Paint and requires "Lead Abatement". This

#### Section IV: Purpose and Methodologies

The purpose of this survey assessment was to identify Asbestos Containing Materials (ACM) and Lead Containing Materials that may be impacted by planned repair, remodel, renovation at the survey location. TRUST Environmental first conducted a visual inspection of the survey location to identify and assess the condition of materials to be sampled.

Bulk material samples of suspected asbestos containing material were collected, categorized into homogenous groupings, labeled a unique sample number for each sample, and placed into a sealed container. Asbestos samples were analyzed via Polarized Light Microscopy (PLM) for asbestos content by an accredited laboratory listed below. Principles described in the EPA 600 method were used in the preparation and analysis of the bulk samples. US EPA government regulation requires that a limited number of samples be collected from each identified homogenous area. If one sample in a homogenous area is determined to be asbestos containing, the entire homogenous area must be considered asbestos containing, even if no asbestos was detected in any other samples within the homogenous area.. No destructive sampling was conducted. As such, any inaccessible areas that would require destructive sampling were not inspected or sampled. All areas that renovation or demolition plans will impact must be inspected or sampled. Asbestos bulk samples were delivered to and analyzed via PLM by an accredited laboratory.

The specific number of samples collected was determined by using the methods required by the Federal AHERA regulations (40 CFR, Part 763.86) as noted below:

1) For Surfacing Material:

1,000 ft<sup>2</sup> or less - collect 3 samples

1,001 to 5,000 ft<sup>2</sup> - collect 5 samples

5,001 ft<sup>2</sup> or greater - collect 7 samples

2) For Thermal System Insulation:

"In a randomly distributed manner" - collect 3 samples

6 linear feet of patching or less - collect 1 sample

cementitious pipe fittings - "In a manner sufficient to determine"

3) For all Miscellaneous Material:

Collect samples "In a manner sufficient to determine whether material is ACM (asbestos containing material) or not ACM."

Lead samples were taken via paint chip and analyzed for lead content.



## Section V: Limitations

TRUST Environmental Solutions presents this report and makes the above recommendations based on limitations of the analytical method, along with independent research and industry consensus. TRUST Environmental and representatives of TRUST Environmental are not licensed as Medical Professionals and can make no medical diagnoses. TRUST Environmental was limited to the conditions and observations present only on the day of inspection. Environmental testing is an imperfect science and Asbestos Surveying is limited. In addition, reports may contain inaccuracies. TRUST Environmental may revise the above content of this report at any time when presented with new information. Any reference to quantities within this report are estimates and are not actual. TRUST Environmental was limited to standard practices, the scope of services, parameters of the analytical method used, and conditions present at the time of inspection.

Thank you for choosing TRUST Environmental Solutions. Please contact us at (805) 72-TRUST or TestIt@TRUSTenv.com for any additional testing needs. Please contact the Reports Department at GetResults@TRUSTenv.com for any questions or requested revisions regarding this report and we would be happy to assist you.

Written By:



David Penglase  
Senior Technical Report Writer  
[GetResults@TRUSTenv.com](mailto:GetResults@TRUSTenv.com)  
(805) 72-TRUST  
TRUST Environmental Solutions

Reviewed By:



Victor Ruiz  
Certified Asbestos Consultant (15-5589) and LRC (00011686)  
[Victor.Ruiz@TrustEnv.com](mailto:Victor.Ruiz@TrustEnv.com)  
TRUST Environmental Solutions  
317 W. Ventura Blvd., #1067  
Camarillo, California 93010

## Section VI: Appendices

Please see below for any relevant analytical results, site diagrams, and certifications regarding the above project.

# APPENDIX A – ANALYTICAL RESULTS AND CHAIN OF CUSTODY



Report for:

**Lab Results**  
**TRUST Environmental Solutions**  
317 Ventura Blvd.  
#1067  
Camarillo, CA 93010

---

Regarding: Eurofins EPK Built Environment Testing, LLC  
Project: 7459; 20813 NE 72nd Ave, Battle Ground, WA  
EML ID: 3763843

Approved by:

A handwritten signature in black ink, appearing to read 'Danny Li', is written over a horizontal line.

Approved Signatory  
Danny Li

Dates of Analysis:  
Asbestos PLM: 08-29-2024

Service SOPs: Asbestos PLM (EPA 40CFR App E to Sub E of Part 763 & EPA METHOD 600/R-93-116, SOP EM-AS-S-1267)  
NVLAP Lab Code 200757-0

---

All samples were received in acceptable condition unless noted in the Report Comments portion in the body of the report. The results relate only to the samples as received and tested. The results include an inherent uncertainty of measurement associated with estimating percentages by polarized light microscopy. Measurement uncertainty data for sample results with >1% asbestos concentration can be provided when requested.

Eurofins EPK Built Environment Testing, LLC ("the Company"), a member of the Eurofins Built Environment Testing group of companies, shall have no liability to the client or the client's customer with respect to decisions or recommendations made, actions taken or courses of conduct implemented by either the client or the client's customer as a result of or based upon the Test Results. In no event shall the Company be liable to the client with respect to the Test Results except for the Company's own willful misconduct or gross negligence nor shall the Company be liable for incidental or consequential damages or lost profits or revenues to the fullest extent such liability may be disclaimed by law, even if the Company has been advised of the possibility of such damages, lost profits or lost revenues. In no event shall the Company's liability with respect to the Test Results exceed the amount paid to the Company by the client therefor.

Client: TRUST Environmental Solutions

C/O: Lab Results

Re: 7459; 20813 NE 72nd Ave, Battle Ground, WA

Date of Receipt: 08-29-2024

Date of Report: 08-29-2024

## ASBESTOS PLM REPORT

**Total Samples Submitted:** 6

**Total Samples Analyzed:** 6

**Total Samples with Layer Asbestos Content > 1%:** 4

### Location: 1A, Kitchen Ceiling, Textured Paint

Lab ID-Version‡: 18547296-1

Sample Layers	Asbestos Content
White Texture with Paint	2% Chrysotile
<b>Sample Composite Homogeneity:</b>	Poor

### Location: 1B, Kitchen Ceiling, Textured Paint

Lab ID-Version‡: 18547297-1

Sample Layers	Asbestos Content
White Texture with Paint	2% Chrysotile
<b>Sample Composite Homogeneity:</b>	Poor

### Location: 2A, Kitchen Ceiling, Joint Compound

Lab ID-Version‡: 18547298-1

Sample Layers	Asbestos Content
Cream Tape	ND
White Joint Compound	2% Chrysotile
<b>Composite Non-Asbestos Content:</b>	10% Cellulose
<b>Sample Composite Homogeneity:</b>	Poor

The test report shall not be reproduced except in full, without written approval of the laboratory. The report must not be used by the client to claim product certification, approval, or endorsement by NVLAP, NIST, or any agency of the federal government. The Company reserves the right to dispose of all samples after a period of thirty (30) days, according to all state and federal guidelines, unless otherwise specified.

All components not quantified as asbestos content and non-asbestos content are considered to be non-fibrous matrix components. Matrix components may include, but are not limited to, gypsum, paint, silicate minerals, vinyl, binder, calcium carbonate, tar, and foam.

Inhomogeneous samples are separated into homogeneous subsamples and analyzed individually. ND means no fibers were detected. When detected, the minimum detection and reporting limit is less than 1% unless point counting is performed. Floor tile samples may contain large amounts of interference material and it is recommended that the sample be analyzed by gravimetric point count analysis to lower the detection limit and to aid in asbestos identification.

‡ A "Version" indicated by "-x" after the Lab ID# with a value greater than 1 indicates a sample with amended data. The revision number is reflected by the value of "x".

Client: TRUST Environmental Solutions

C/O: Lab Results

Re: 7459; 20813 NE 72nd Ave, Battle Ground, WA

Date of Receipt: 08-29-2024

Date of Report: 08-29-2024

## ASBESTOS PLM REPORT

### Location: 2B, Kitchen Ceiling, Joint Compound

Lab ID-Version‡: 18547299-1

Sample Layers	Asbestos Content
Cream Tape	ND
White Joint Compound	2% Chrysotile
<b>Composite Non-Asbestos Content:</b>	10% Cellulose
<b>Sample Composite Homogeneity:</b>	Poor

### Location: 3A, Kitchen Ceiling, Drywall

Lab ID-Version‡: 18547300-1

Sample Layers	Asbestos Content
White Drywall with Brown Paper	ND
<b>Composite Non-Asbestos Content:</b>	10% Cellulose
<b>Sample Composite Homogeneity:</b>	Poor

### Location: 3B, Kitchen Ceiling, Drywall

Lab ID-Version‡: 18547301-1

Sample Layers	Asbestos Content
White Drywall with Brown Paper	ND
<b>Composite Non-Asbestos Content:</b>	10% Cellulose
<b>Sample Composite Homogeneity:</b>	Poor

The test report shall not be reproduced except in full, without written approval of the laboratory. The report must not be used by the client to claim product certification, approval, or endorsement by NVLAP, NIST, or any agency of the federal government. The Company reserves the right to dispose of all samples after a period of thirty (30) days, according to all state and federal guidelines, unless otherwise specified.

All components not quantified as asbestos content and non-asbestos content are considered to be non-fibrous matrix components. Matrix components may include, but are not limited to, gypsum, paint, silicate minerals, vinyl, binder, calcium carbonate, tar, and foam.

Inhomogeneous samples are separated into homogeneous subsamples and analyzed individually. ND means no fibers were detected. When detected, the minimum detection and reporting limit is less than 1% unless point counting is performed. Floor tile samples may contain large amounts of interference material and it is recommended that the sample be analyzed by gravimetric point count analysis to lower the detection limit and to aid in asbestos identification.

‡ A "Version" indicated by "-x" after the Lab ID# with a value greater than 1 indicates a sample with amended data. The revision number is reflected by the value of "x".



Report for:

**Lab Results**  
**TRUST Environmental Solutions**  
317 Ventura Blvd.  
#1067  
Camarillo, CA 93010

---

Regarding: Eurofins EPK Built Environment Testing, LLC  
Project: 7459; 20813 NE 72nd Ave, Battle Ground, WA  
EML ID: 3763843

Approved by:



Approved Signatory  
Andrew Arestegui

Dates of Analysis:

Lead - Flame AA: 08-29-2024

Service SOPs: Lead - Flame AA (EM-BC-S-8443)  
AIHA LAP, LLC accredited service, Lab ID #178697

---

All samples were received in acceptable condition unless noted in the Report Comments portion in the body of the report. Due to the nature of the analyses performed, field blank correction of results is not applied. The results relate only to the samples as received and tested. Sample size, as it relates to Wipe samples only, is supplied by the client.

Eurofins EPK Built Environment Testing, LLC ("the Company"), a member of the Eurofins Built Environment Testing group of companies, shall have no liability to the client or the client's customer with respect to decisions or recommendations made, actions taken or courses of conduct implemented by either the client or the client's customer as a result of or based upon the Test Results. In no event shall the Company be liable to the client with respect to the Test Results except for the Company's own willful misconduct or gross negligence nor shall the Company be liable for incidental or consequential damages or lost profits or revenues to the fullest extent such liability may be disclaimed by law, even if the Company has been advised of the possibility of such damages, lost profits or lost revenues. In no event shall the Company's liability with respect to the Test Results exceed the amount paid to the Company by the client therefor.

Eurofins EPK Built Environment Testing, LLC's LabServe® reporting system includes automated fail-safes to ensure that all AIHA LAP, LLC quality requirements are met and notifications are added to reports when any quality steps remain pending.

Client: TRUST Environmental Solutions

C/O: Lab Results

Re: 7459; 20813 NE 72nd Ave, Battle Ground, WA

Date of Receipt: 08-29-2024

Date of Report: 08-29-2024

**LEAD: FLAME ATOMIC ABSORPTION SPECTROMETRY**

Location:	PB-1: Kitchen Ceiling, White Paint
Comments (see below)	A
Lab ID-Version‡:	18547302-1
Analysis Date:	08/29/2024
Sample type	Paint Chip sample
Method*	NIOSH 7082 & EPA 7000B modified
† Method Reporting Limit	40 ppm
Sample size	0.2509 grams
§ Total Lead Result	< 40 ppm

**Comments:** A) The relative percent difference of the matrix duplicate pair was above control limits. The laboratory control sample and matrix blank were both within control limits and validated the batch.

Sample results have not been corrected for blank values.

Bulk samples are not covered under the AIHA LAP, LLC service accreditation.

Wipe samples must meet ASTM E1792 criteria. Method Reporting Limits may not be valid for non-ASTM E1792 wipe samples.

\*Sample preparation and analytical methods are based upon NIOSH 7082 and EPA 7000B.

† The Method Reporting Limit is the minimum concentration of Lead that the laboratory can confidently detect in the sample.

§ Total Lead Result has been rounded to two significant figures to reflect analytical precision.

‡ A "Version" indicated by "-x" after the Lab ID# with a value greater than 1 indicates a sample with amended data. The revision number is reflected by the value of "x".



Environmental  
Solutions

Results Begin With TRUST

TRUST Environmental Solutions

317 W Ventura Blvd., #1067, Camarillo, CA 93010

(805) 72-TRUST | www.TRUSTenv.com | TestIt@TRUSTenv.com

# ASBESTOS & LEAD CHAIN OF CUSTODY RECORD

TRUST Assignment #: 7459

TAT Requested: ☒ 3HR ☐ 24HR ☐ Other \_\_\_\_\_

Client Name: Service Master

Analysis Requested: ☒ PLM ☐ TEM (Wipe) ☐ TEM (MV) ☐ PCM

Site Name: Mumm, James

☒ Lead Paint Chip ☐ Other \_\_\_\_\_

Site Address: 20813 NE 72<sup>nd</sup> Ave, Battle Ground, WA

Sample Count (Specify Type) \_\_\_\_\_

Sample ID	Collection Location	Material Type	F	NF	Condition	Total (Vol./Size)	Additional Notes (Color, P5, etc.)
1A, 1B	Kitchen Ceiling	Texture Paint	X		Damage	600SF	
2A, 2B		Joint Compound	X				
3A, 3B		Drywall	X				
PB-1		White Paint					



003763843

Date & Time: 8/28/24 11:45

Company Name: TRUST Environmental Solutions

Sampling Technician (Print): Alex Abrahamson

Sampling Technician (Sign): [Signature]

Date & Time: 8/29/24 15:05

Company Name: Environ Built Environment

Laboratory Recipient (Print): STEVEN CASTILLO

Laboratory Recipient (Sign): Received By [Signature]

Page \_\_\_\_ of \_\_\_\_



## APPENDIX B – SITE DIAGRAM

## SITE DIAGRAM

TRUST Assignment #: 7459

Client Name: Service Master

Assigned Technician: Alex Abrahamson

Site Name: MUMM, James

Testing Type: Asbestos/Lead

Revisit: ☐ Yes ☒ No

Site Address: 20813 NE 72nd Avenue  
Battle Ground, WA, 98604

Survey Type: ☐ Full ☒ Limited ☐ Other

P5: ☐ Yes ☐ No ☐ N/A

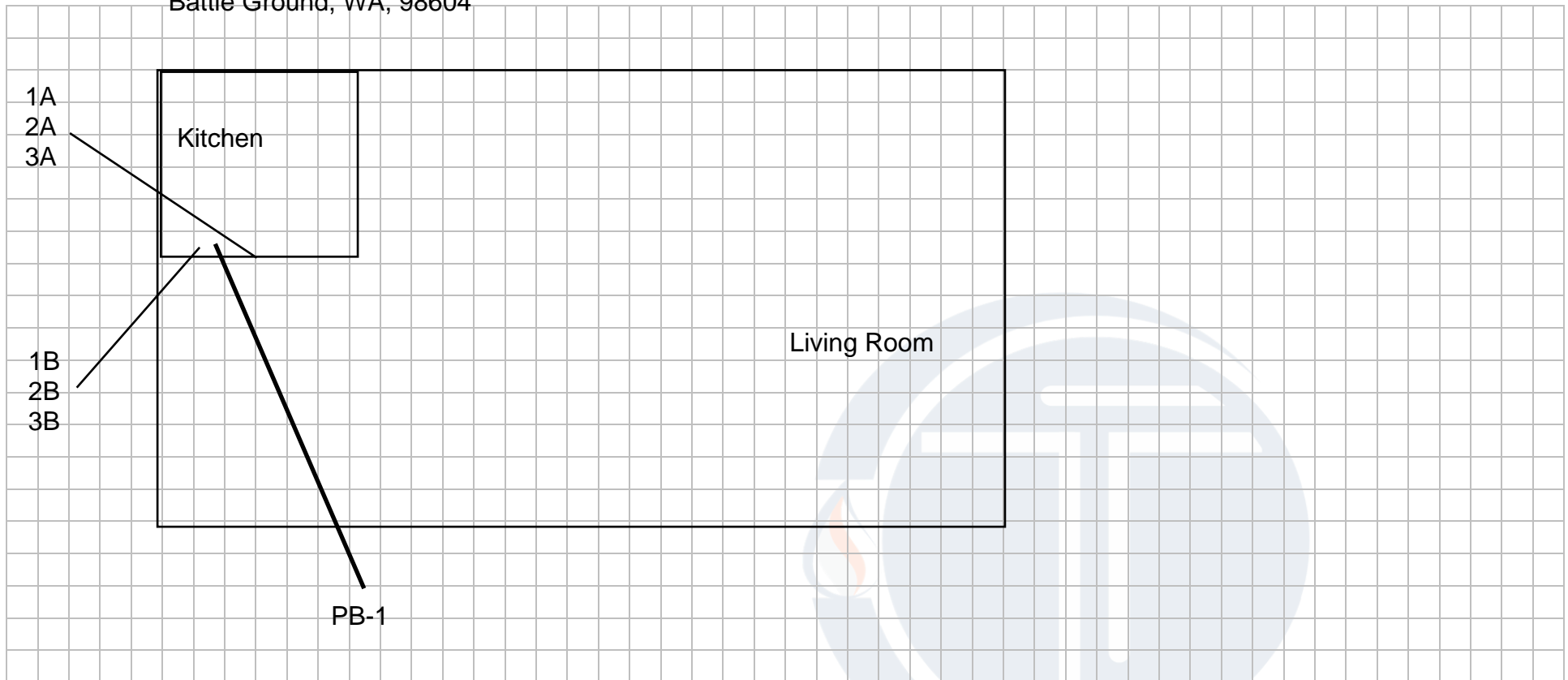

Elevated Moisture: —  
Water Damage: —  
Visible Growth: —

## APPENDIX C – CERTIFICATIONS

# Certificate of Completion

This is to certify that

**Alex J. Abrahamson**

has satisfactorily completed  
4 hours of online refresher training as an  
**AHERA Building Inspector**

to comply with the training requirements of  
**TSCA Title II, 40 CFR 763 (AHERA)**

EPA Provider # 1085

192231  
Certificate Number



Instructor: David Welch

Jan 17, 2024

Expires in 1 year.

Date(s) of Training

Exam Score: N/A  
(if applicable)



- Facilities
- Environmental
- Geotechnical
- Materials